

RG-AP520(W2)

V1.04

2023-04-07

copyright © 2023

copyright © 2023



[https](#)

2.

1

RG-AP520(W2)

AP
1.167Gbps

2.4G

300Mbps

5G

802.11ac wave2

867Mbps

1.1 RG-AP520(W2)

2.4G

"

1.3 RG-AP520(W2)

ap

	—			AP	/
	3Hz			AP	
	—			AP	
	3Hz			AP	Link down
	3Hz			AP	CAPWAP
	3Hz			AP	
	—			AP	CAPWAP
		16	/min	AP	CAPWAP
	—			AP	
AP 46%	3Hz	2	2	AP	AP

ap

	—			AP	/
	3Hz			AP	
	—			AP	
	3Hz			AP	Link down
	3Hz			AP	
	—			AP	



2



RG-AP520(W2)



2.2



AP



500m



2.3



2.4



- AP



NO ₂	0.04	0.15
NH ₃	0.05	0.15
Cl ₂	0.01	0.3

2.5.5

- DC11.4-12.6V 1.5A

1.35mm	3.5mm	9mm	

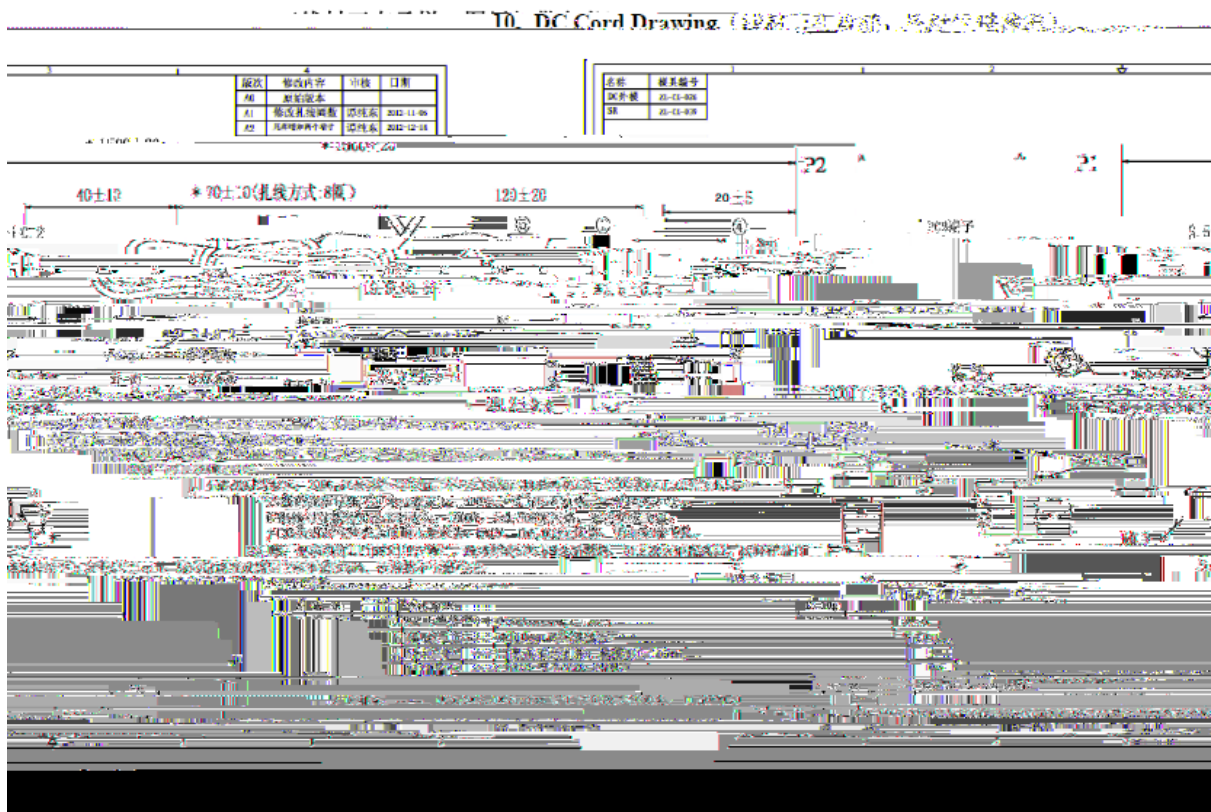

- PoE 802.3af/802.3at PoE

2.5.6 EMI

-
-

2.6

 RG-AP520(W2)

2.7



3

RG-AP520(W2) AP



a

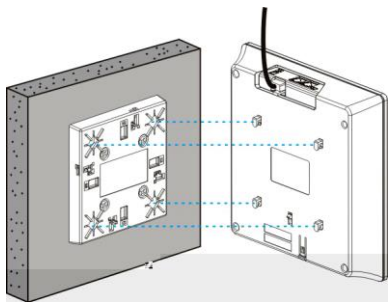

3)

3-6

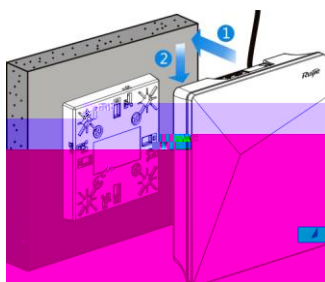

" Ruijie" logo

3.5

1)

3-7

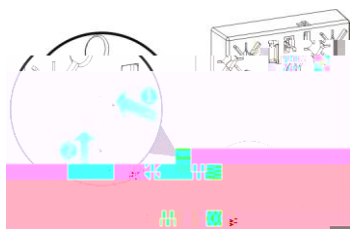

2)

3-8

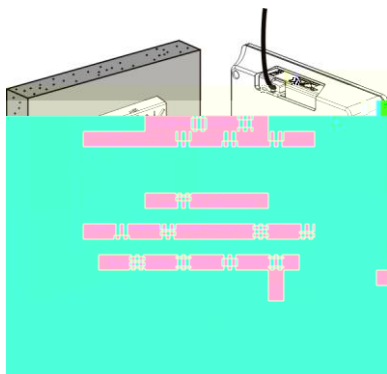

3)

3-9

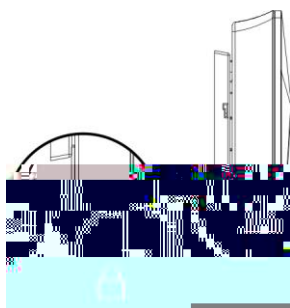

3.6

1)

3-10

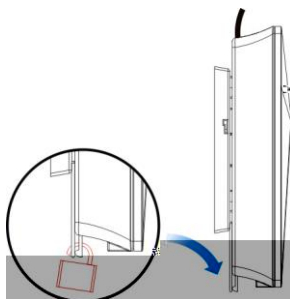

2)

3-11

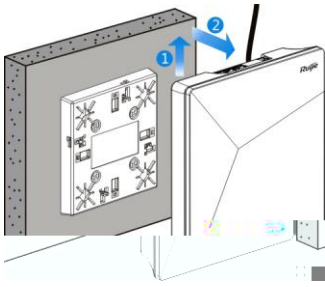

3)

1) LAN/PoE

2)

3)

3.9

■

■

■

■

■

■

■

■

AP

4

4.1

PoE AP

- PoE AP
- AP AC
- PC AP PC PoE

4.2

-
- AP

5

5.1

6

6.1

6.2

- PoE PoE 802.11af
-

50p.

4)

AP

1

10

AC

AP

AC

CAPWAP

A

1000BASE-T/100BASE-TX/10BASE-T

1000BASE-T/100BASE-TX/10BASE-T

MDI/MDIX Crossover

1000BASE-T	IEEE 802.3ab	100-ohm 5	5	UTP	STP
	100				

1000BASE-T	4	4	1000BASE-T
------------	---	---	------------

A-1 1000BASE-T	4
----------------	---

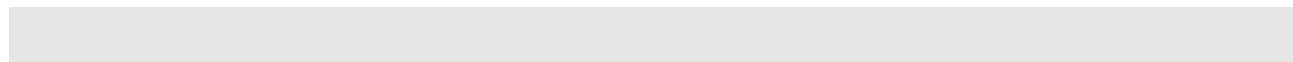

Switch	Switch	Switch	Switch
1 TP0 +	1 TP0 +	1 TP0 +	1 TP0 +
2 TP0 -	2 TP0 -	2 TP0 -	2 TP0 -
3 TP1 +	3 TP1 +	3 TP1 +	3 TP1 +
6 TP1 -	6 TP1 -	6 TP1 -	6 TP1 -
4 TP2 +	4		

RG-AP520(W2)



D-2

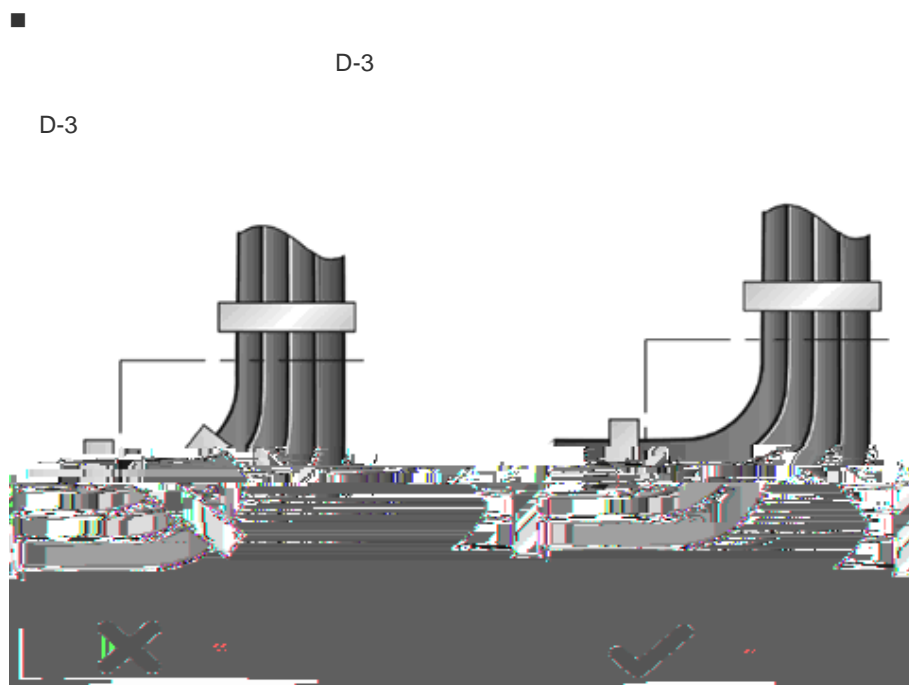

- - 220V -48V

-

- D-4

D-4

